

<b>Car</b>	BMW M140i / M240i / 340i / 440i, including XDrive	<b>Part No.</b>	SBMC074
<b>Year</b>	2015-2020	<b>Fit Kits</b>	386FK
<b>Notes</b>	Where not supplied use original fittings Vacuum blanking cap supplied for GPF models	<b>Features</b>	Pipe Diameter:- 101mm

Estimated Fitting Time: 1 Hour 30 Minutes

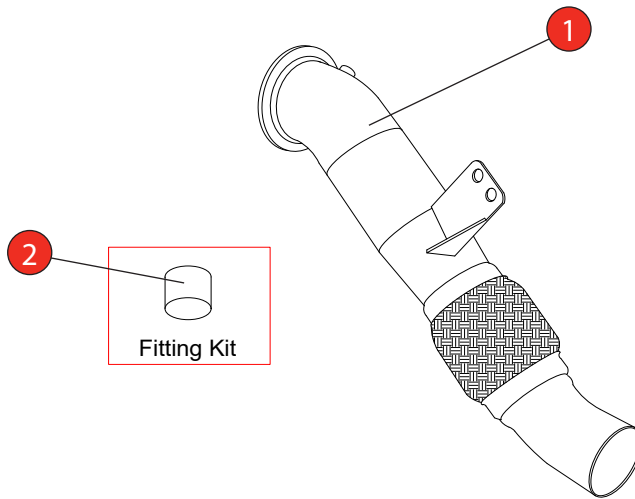

NO.	PART NO.	DESCRIPTION	QTY	CLASSIFICATION	Motorsport Use Only
1	725BM	De-cat Downpipe	1	HOMOLOGATED	No
<b>Fit Kit</b>				DATE	12/07/2023
2	386FK	Black Silicone Vacuum Blanking Cap - 8mm	1	ISSUE	05
				AUTHORISED	S Shipley

**NOTE:** ENSURE SCORPION SYSTEM IS CLEAR OF MOVING PARTS AND ALL ORIGINAL FUNCTIONS WORK CORRECTLY.

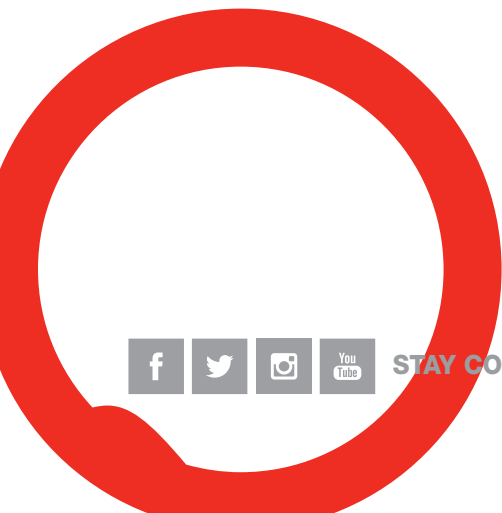

STAY CONNECTED TO RED POWER.

<b>Car</b>	BMW M140i / M240i / 340i / 440i, including XDrive	<b>Part No.</b>	SBMC074
<b>Year</b>	2015-2020	<b>Fit Kits</b>	386FK
<b>Notes</b>	Where not supplied use original fittings Vacuum blanking cap supplied for GPF models	<b>Features</b>	Pipe Diameter:- 101mm

Estimated Fitting Time: 1 Hour 30 Minutes

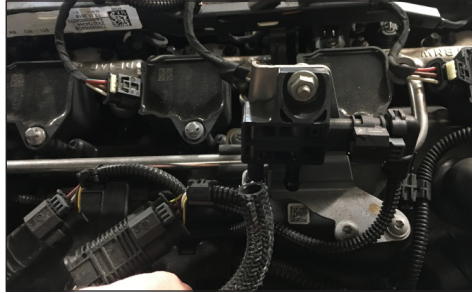

Blanking Cap Instructions  
 (GPF models only):

Locate the vacuum line running between the downpipe and the pressure sensor on the engine.

Remove the vacuum line from the sensor.

Push the blanking cap onto the sensor port that the vacuum pipe was on.



Gasket:  
 Remove the gasket from the original downpipe and re-install on the Scorpion downpipe

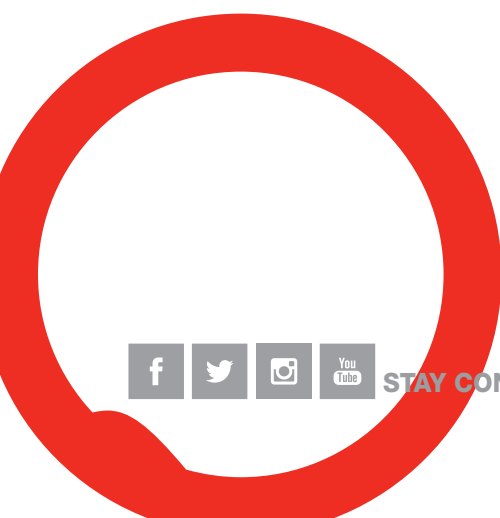

STAY CONNECTED TO RED POWER.